



Installation Guide

Mounting/System Types

- 2 **Wall Bracket Mounting**
- 4 **Wall Bracket Mounting - With Joining Connector(s)**
- 7 **Channel Bracket Mounting**
- 9 **Top Tray Bracket Mounting**
- 11 **Plate Bracket Mounting**
- 13 **Double Sided Bracket Mounting**
- 16 **Optimum Lighting Chart Mounting**



Contact Us

Main Office

Sign Supplier
Unit 15 Dale Industrial Estate
Radcliffe
Manchester
M26 1AD

Contact

0800 133 7555
info@signsupplier.co.uk



SIGN SUPPLIER

Wall Bracket Mounting

Tools Required

- Drill
- Tape Measure
- Screwdriver (Phillips)
- Hex Key



Step 1:

Mount the brackets to the wall in the desired position.

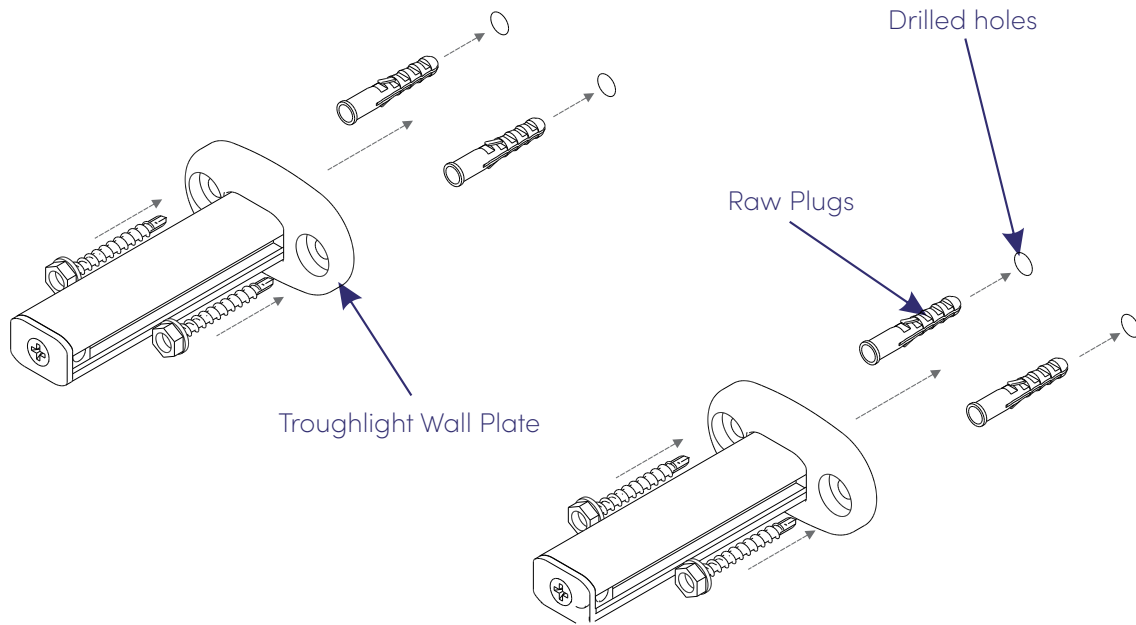

Step 2:

Slot the sliders (mounted on the troughlight) over the wall bracket arms and bolt into place using the tooth washers & M6 bolts.

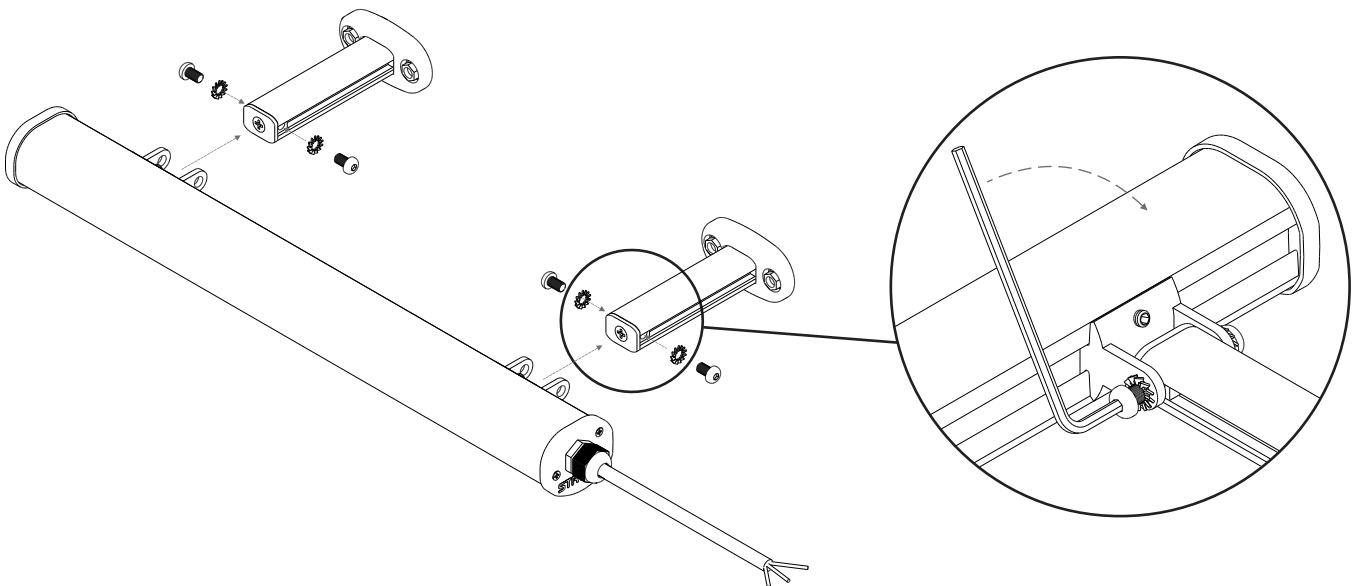

Step 3:

Slide troughlight into position, then tighten the Grub Screws in the Slider Bracket to clamp the troughlight into place.

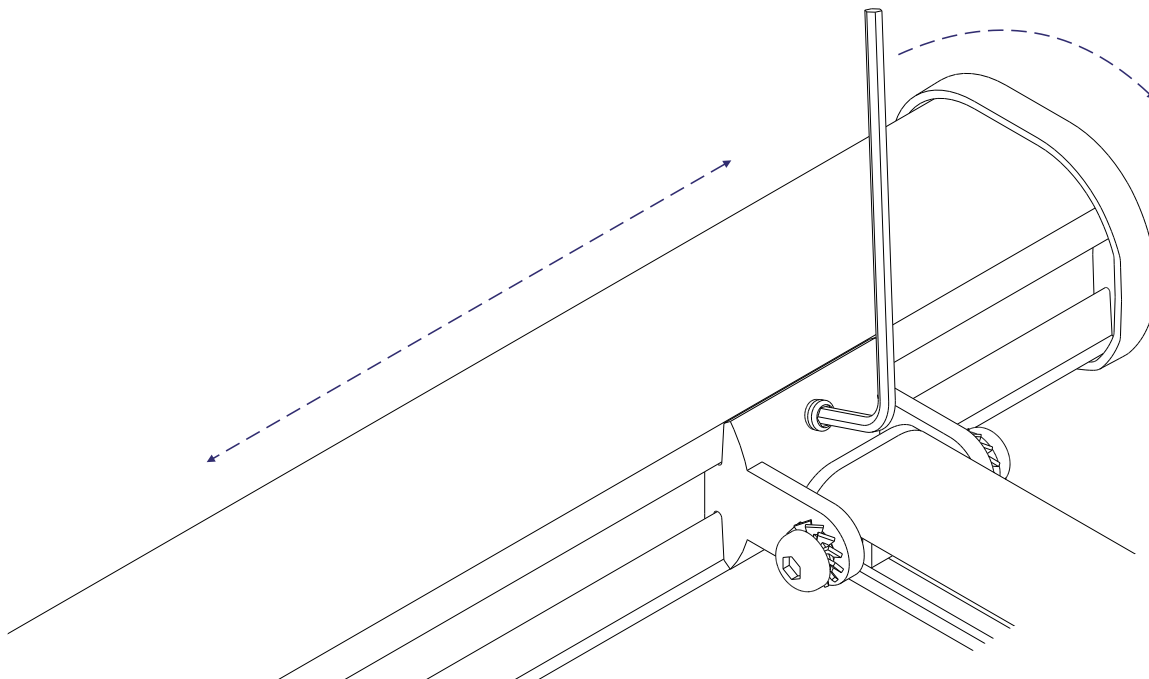

Step 4:

Connect the 3-core cable and the troughlight is complete - Get a qualified electrician to connect your 240V Cable to the mains.

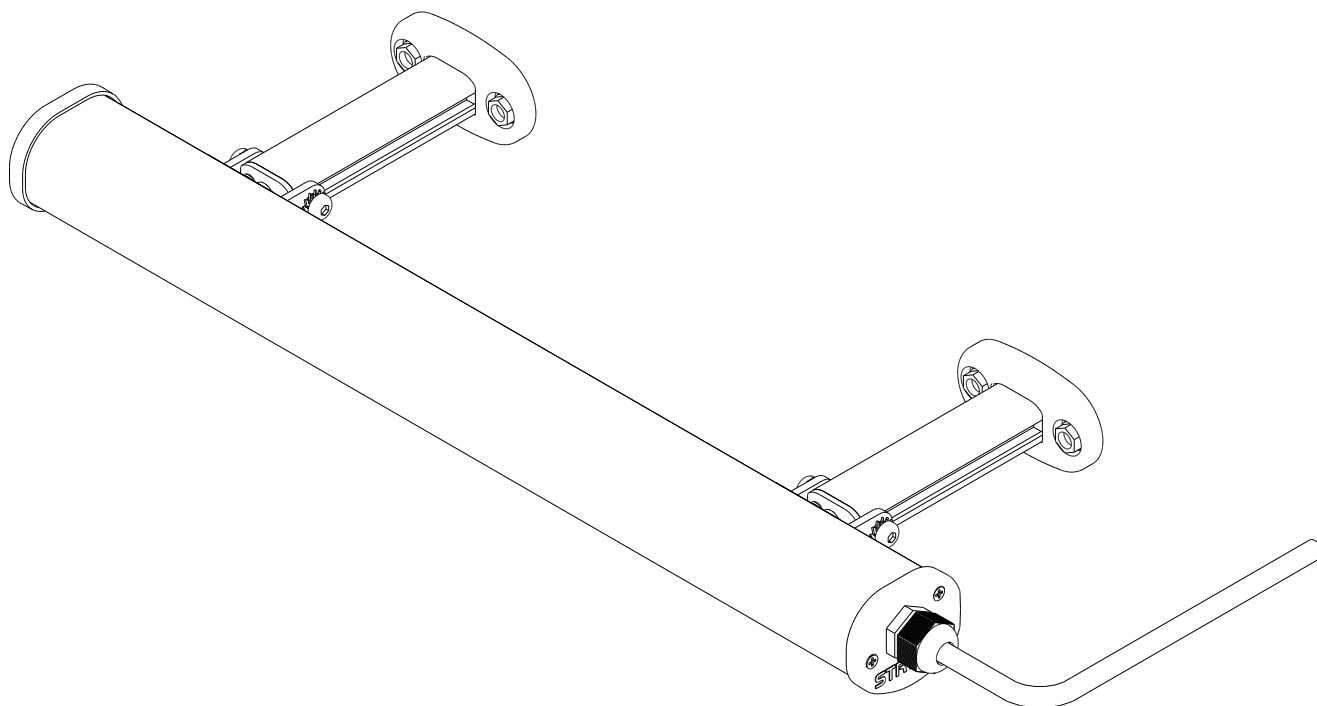

Wall Bracket Mounting - With Joining Connector(s)

Tools Required

- Drill
- Tape Measure
- Screwdriver (Phillips)
- Hex Key



Step 1:

Mount the brackets to the wall in the desired position.

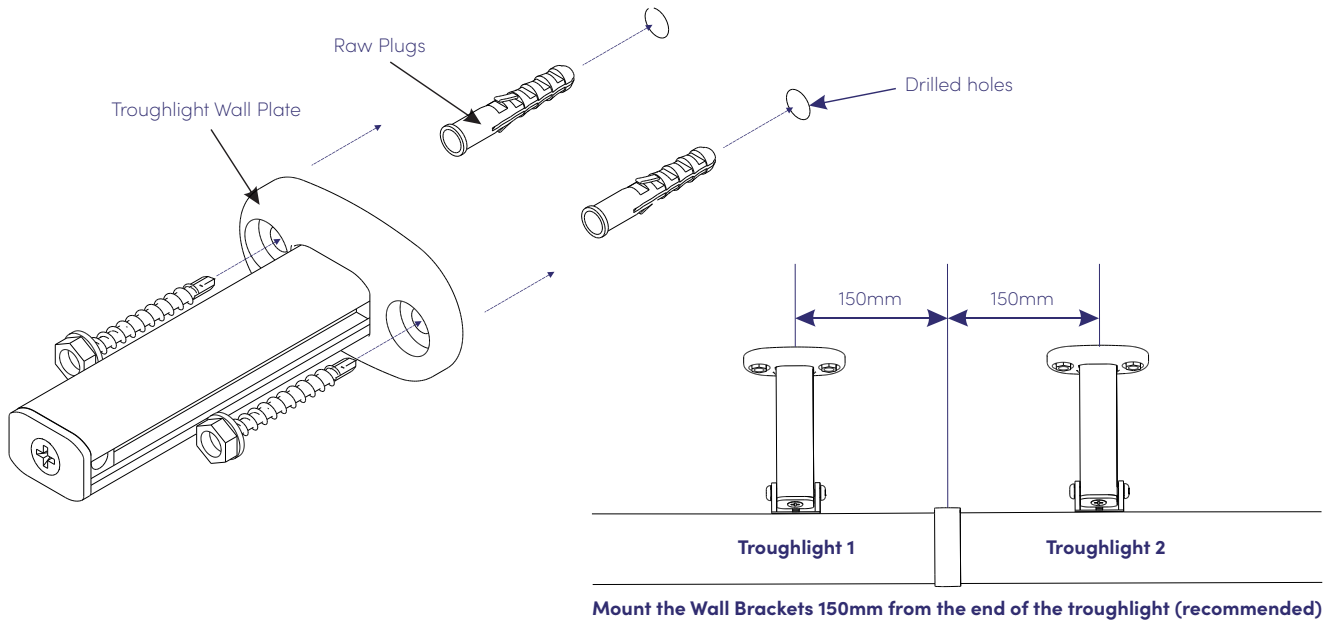

Step 2:

Slot the sliders (mounted on the troughlight) over the wall bracket arms and bolt into place using the tooth washers & M6 bolts.

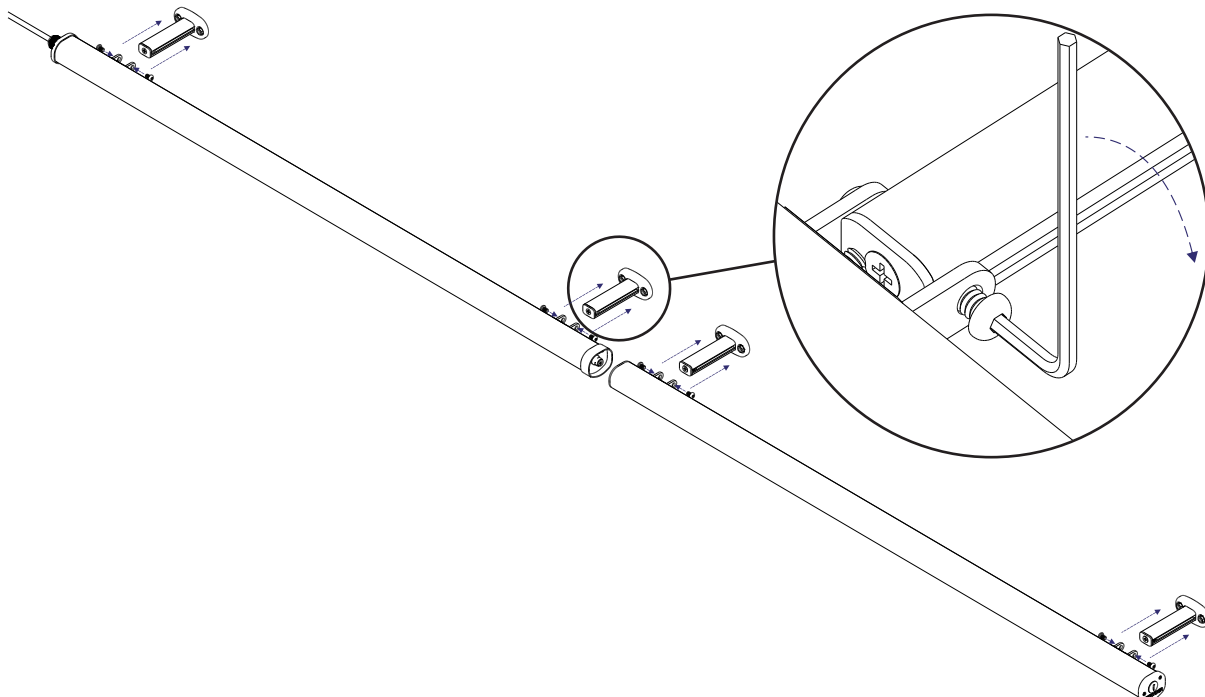

Step 3:

Slide the troughlight along the brackets and female electrical connection onto the male connector.

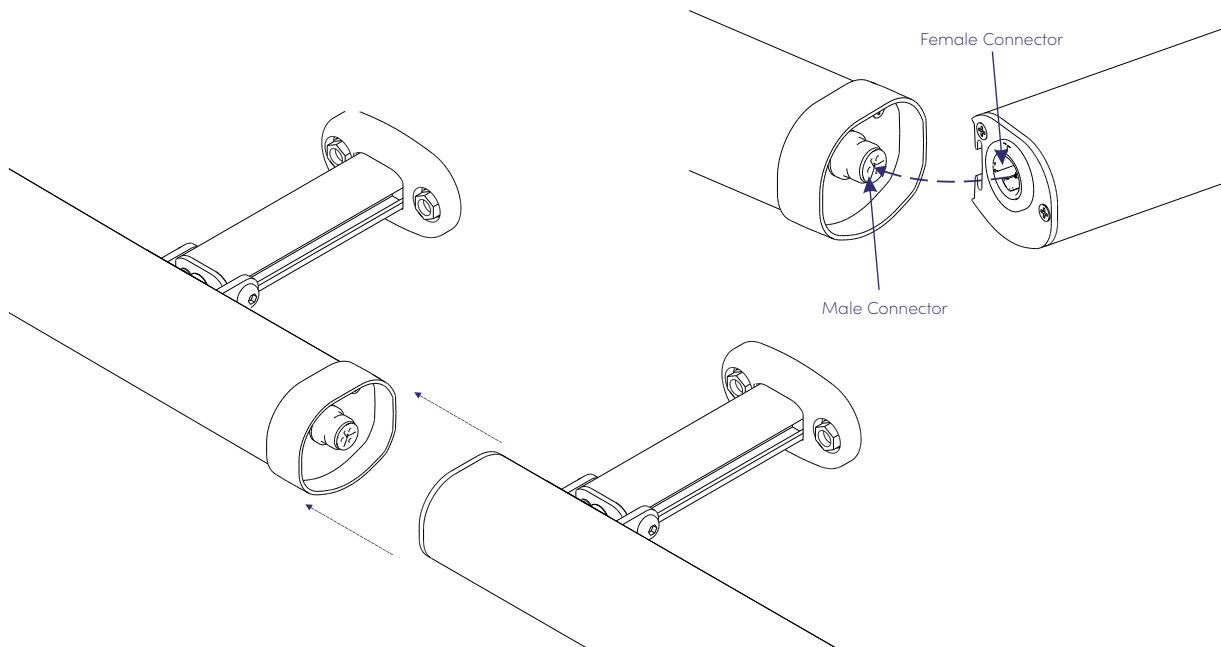

Step 4:

Tighten the Grub Screws in the Slider Bracket to clamp the troughlights into place.

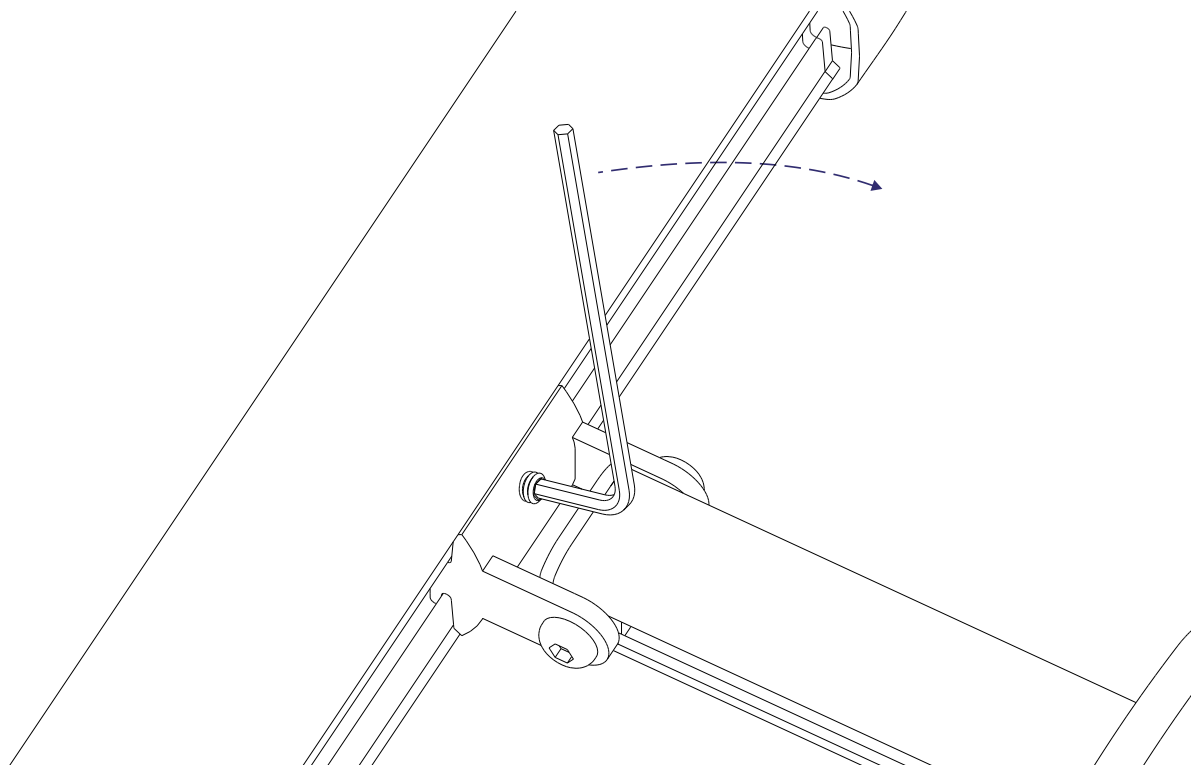

Step 5:

Connect the 3-core cable and the troughlight is complete - Get a qualified electrician to connect your 240V Cable to the mains.

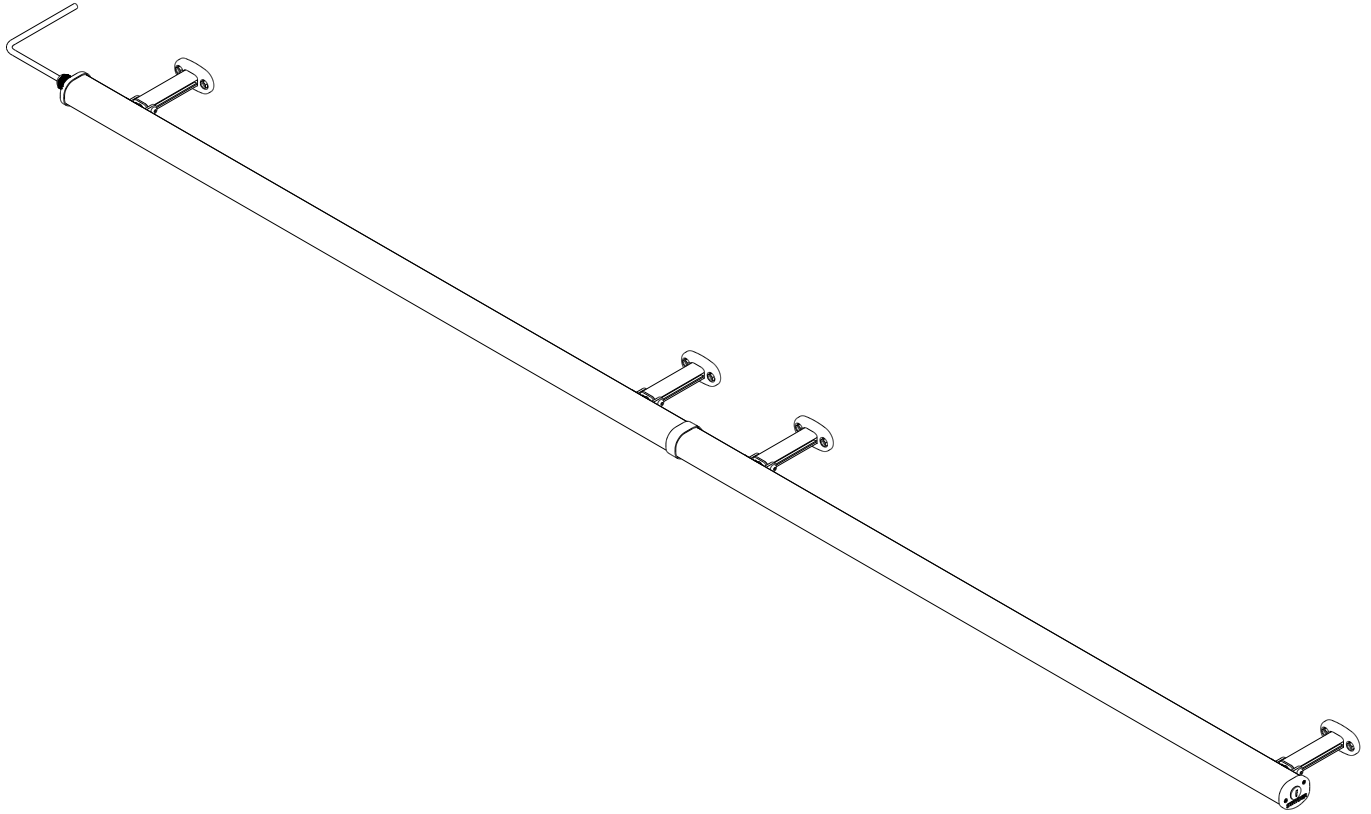

Channel Bracket Mounting

Tools Required

- Spanner
- Hex Key



Step 1:

Fixing the Brackets to the channel on the back of the panel in the desired position.

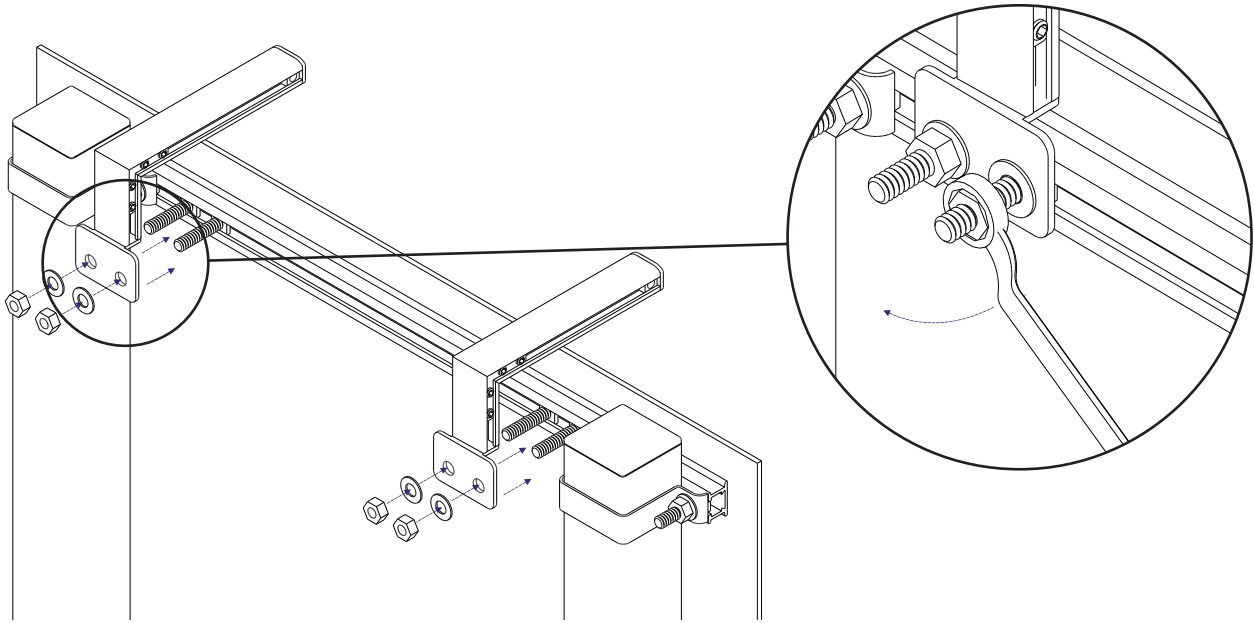

Step 2:

Slot the sliders (mounted on troughlight) over the Channel Bracket arms and bolt in place using the external tooth washers/M6 bolts

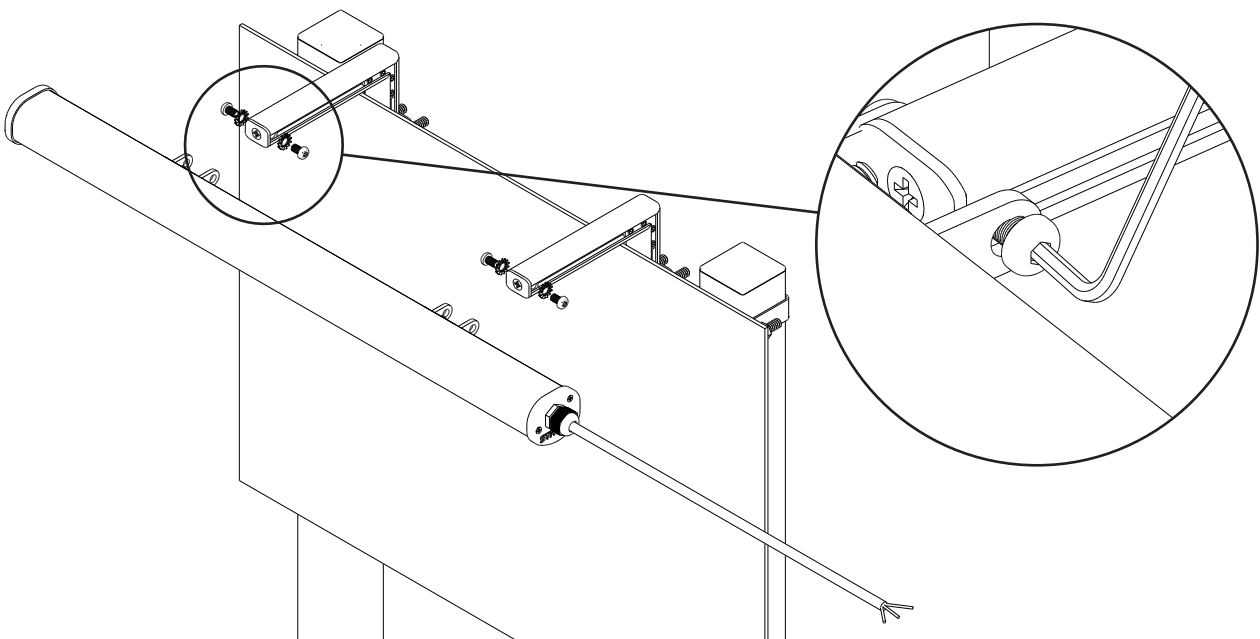

Step 3:

Tighten the Grub Screws in the Slider Bracket to clamp the troughlights into place.

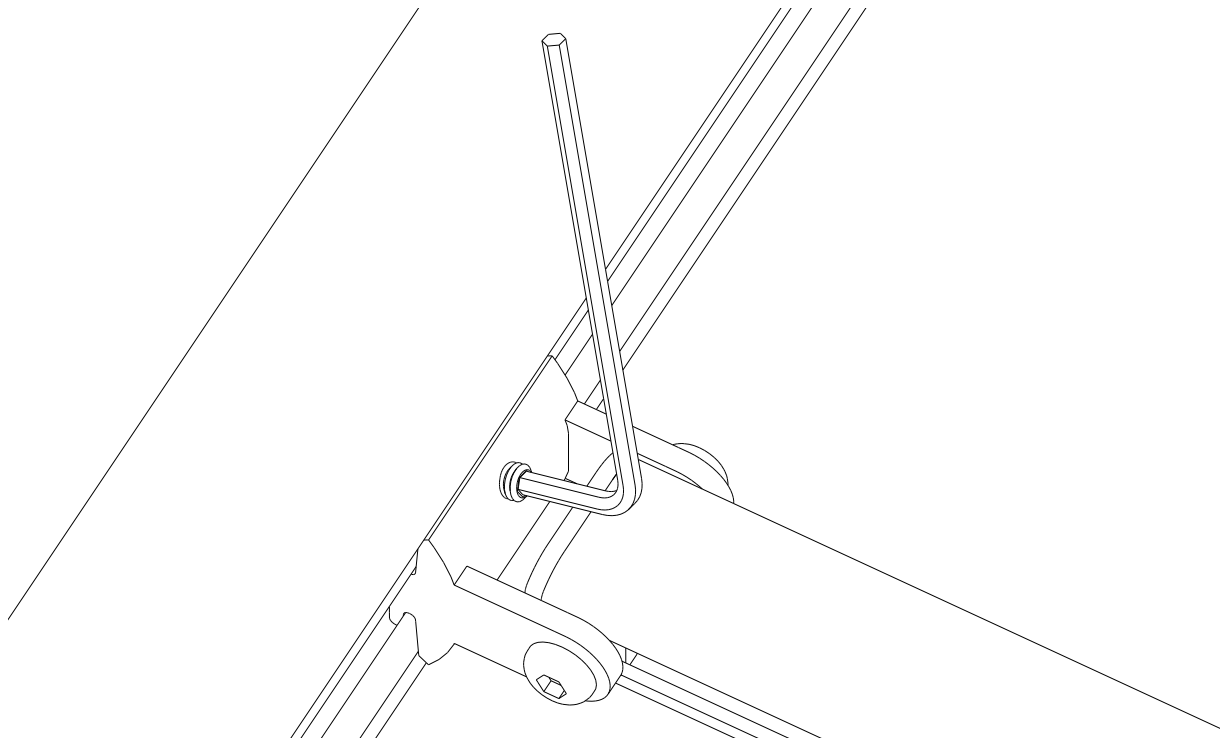

Step 4:

Connect the 3-core cable and the troughlight is complete - Get a qualified electrician to connect your 240V Cable to the mains.

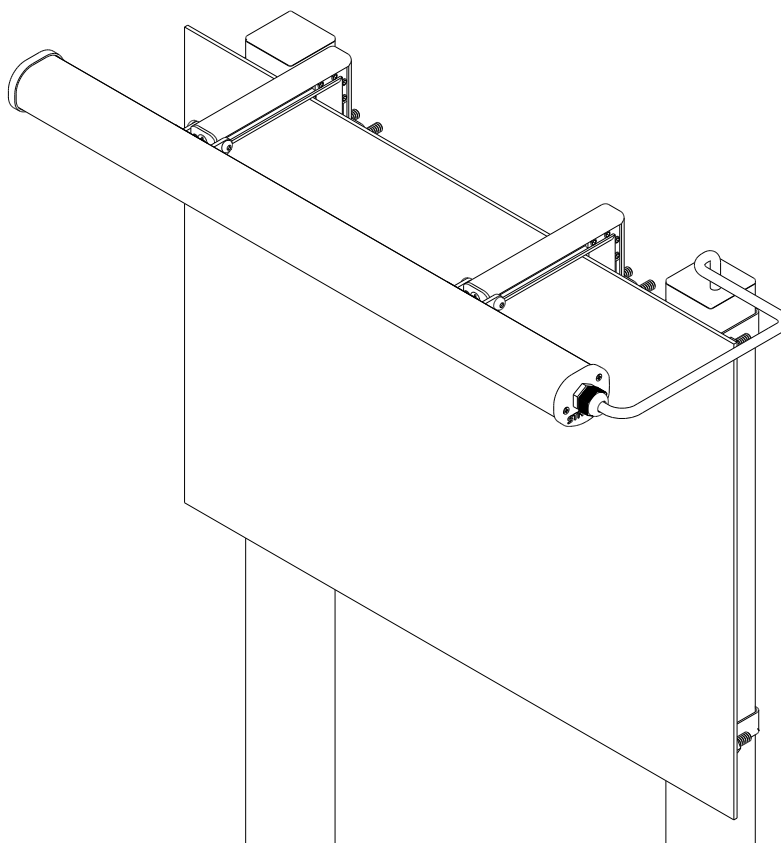

Top Tray Bracket Mounting

Tools Required

- Drill
- Rivet Gun
- Hex Key



Step 1:

Place the Tray Brackets to the tray in the desired position, drill holes then rivet or bolt into place.

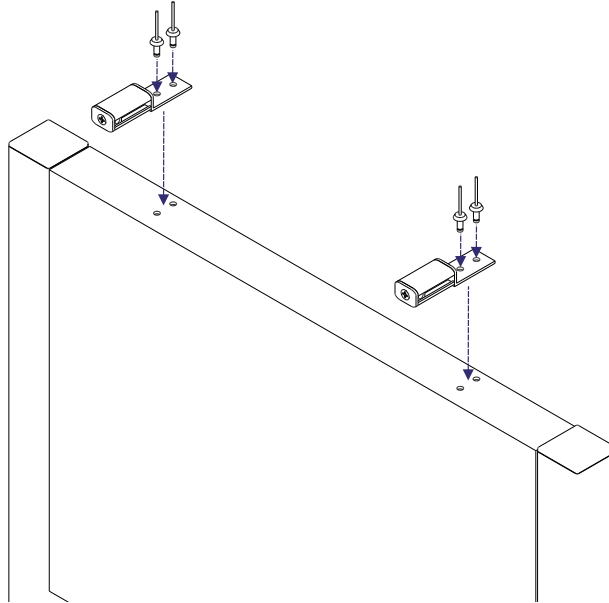

Step 2:

Slot the sliders (mounted on troughlight) over the Tray Bracket arms and bolt into place using M6 bolts

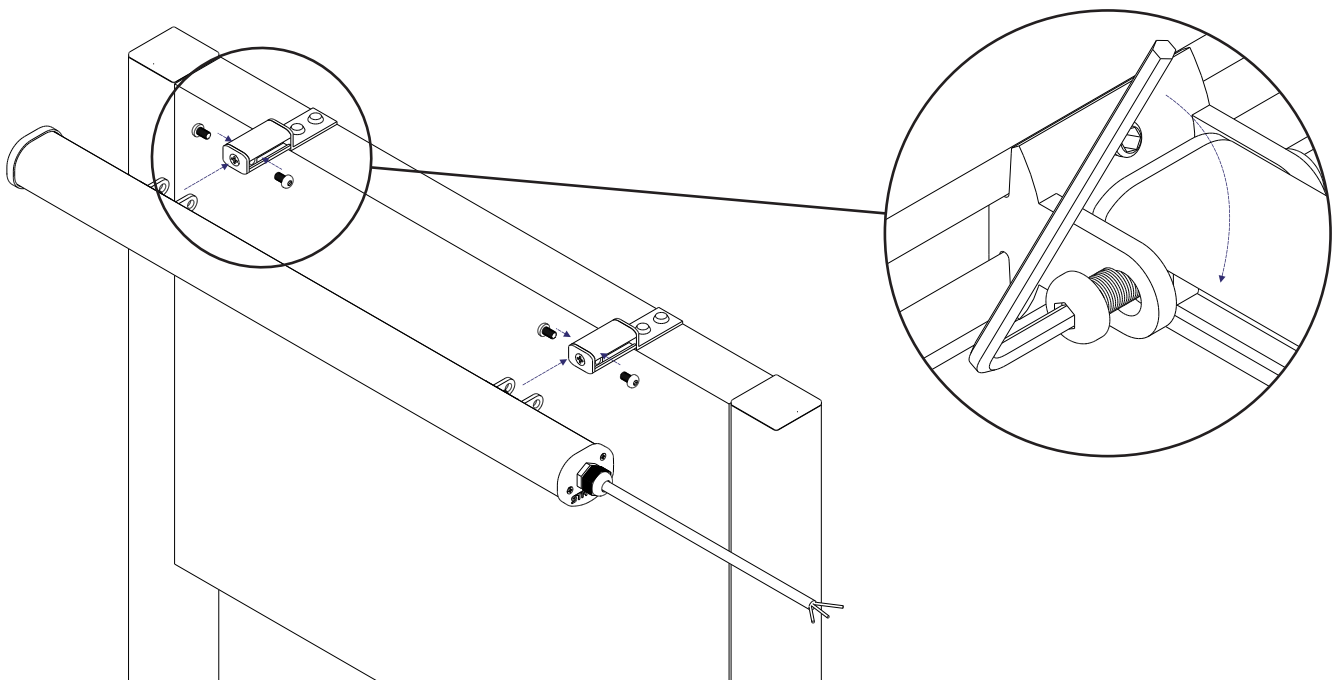

Step 3:

Tighten the Grub Screws in the Slider Bracket to clamp the troughlights into place.

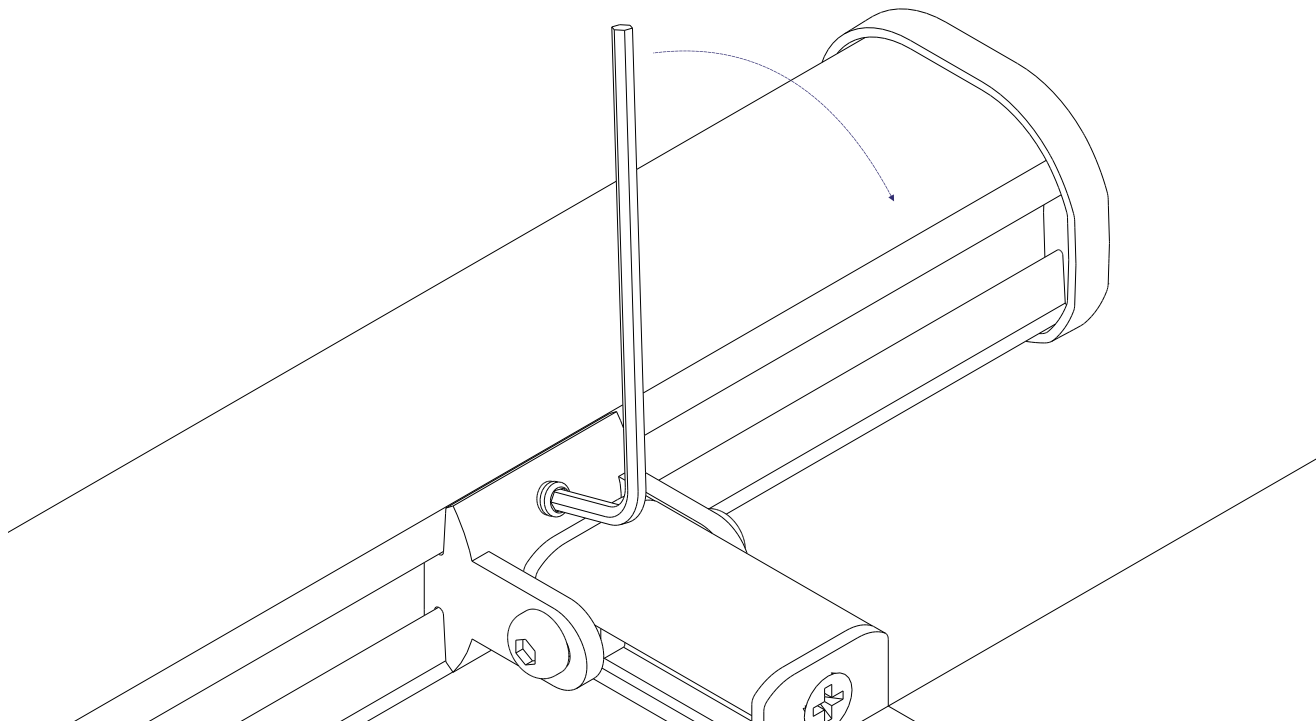

Step 4:

Connect the 3-core cable and the troughlight is complete - Get a qualified electrician to connect your 240V Cable to the mains.

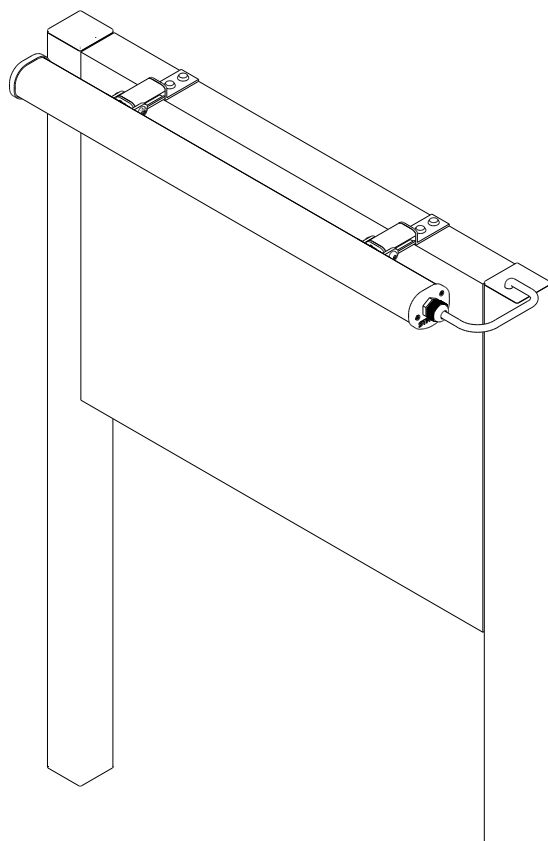

Plate Bracket Mounting

Tools Required

- Drill
- Rivet Gun
- Hex Key



Step 1:

Place the Plate Brackets to the Plate in the desired position, drill holes then rivet or bolt into place.

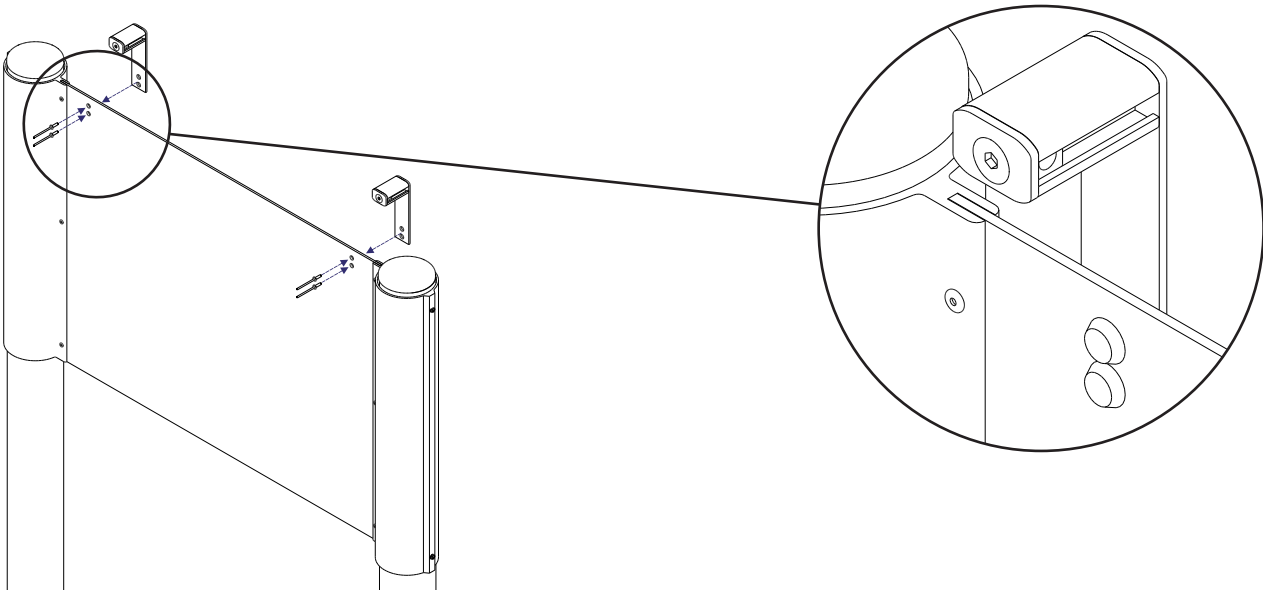

Step 2:

Slot the sliders (mounted on the troughlight) over the Plate Bracket arms and bolt into place using M6 bolts.

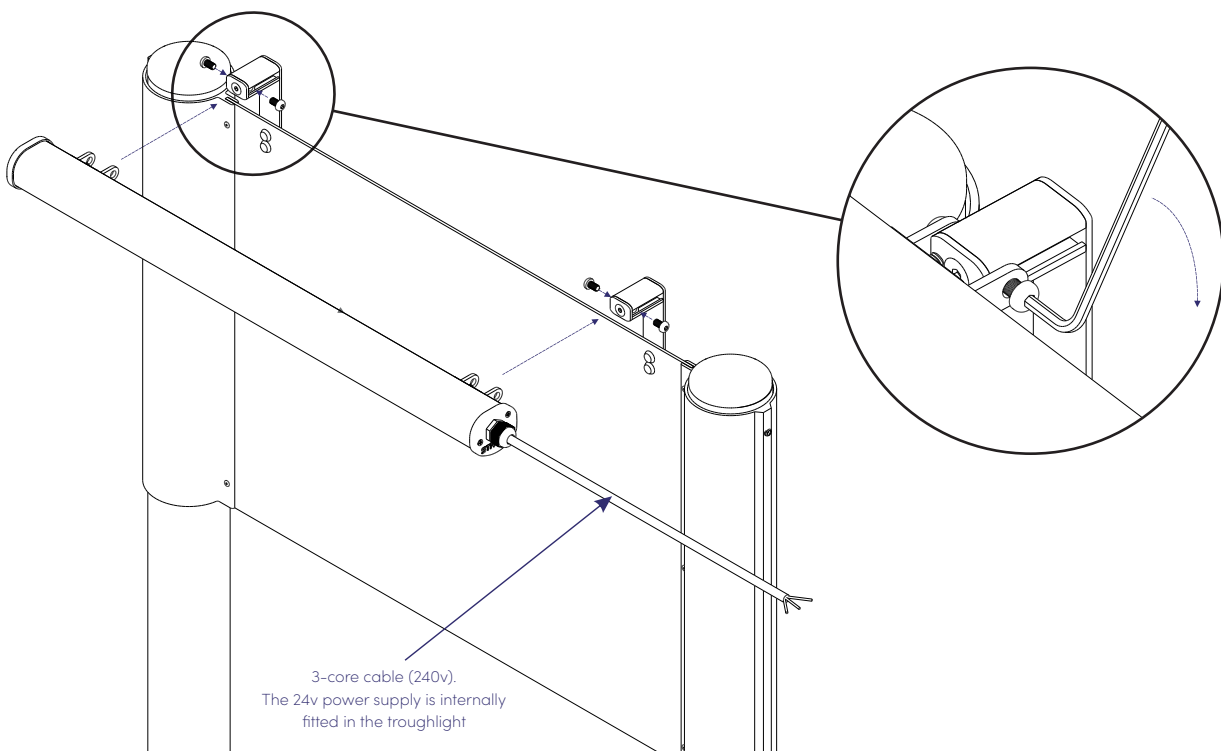

Step 3:

Tighten the Grub Screw in the Slider Bracket to clamp the troughlight into place.

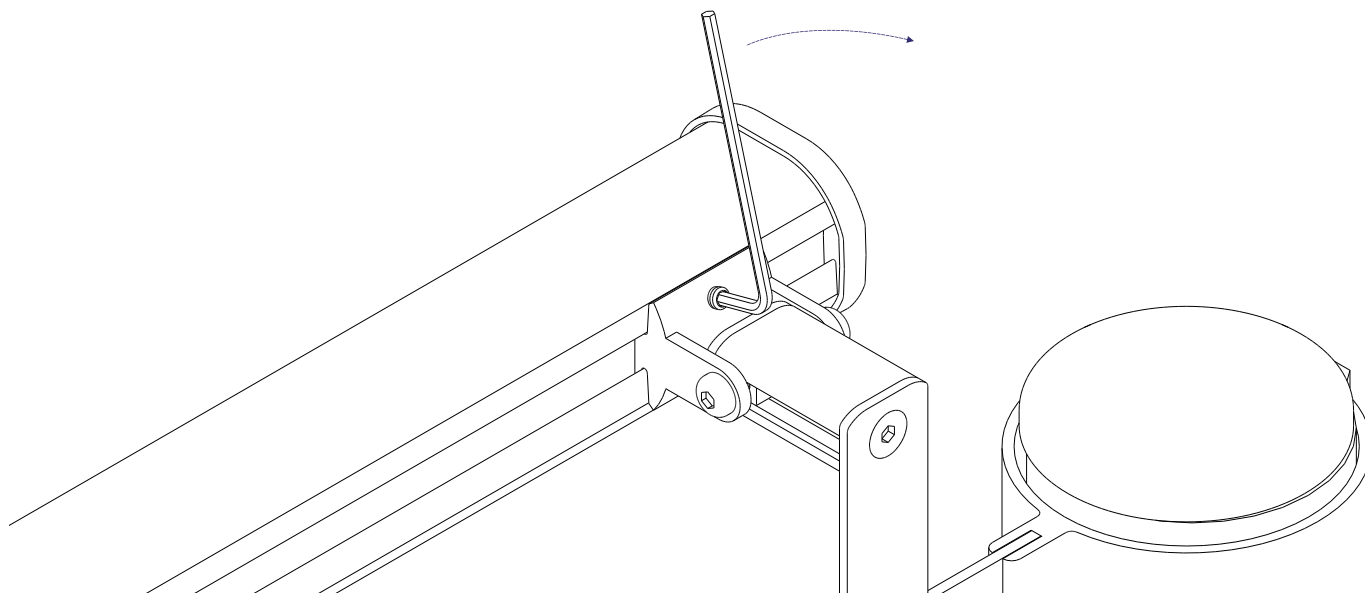

Step 4:

Connect the 3-core cable and the troughlight is complete - Get a qualified electrician to connect your 240V Cable to the mains.

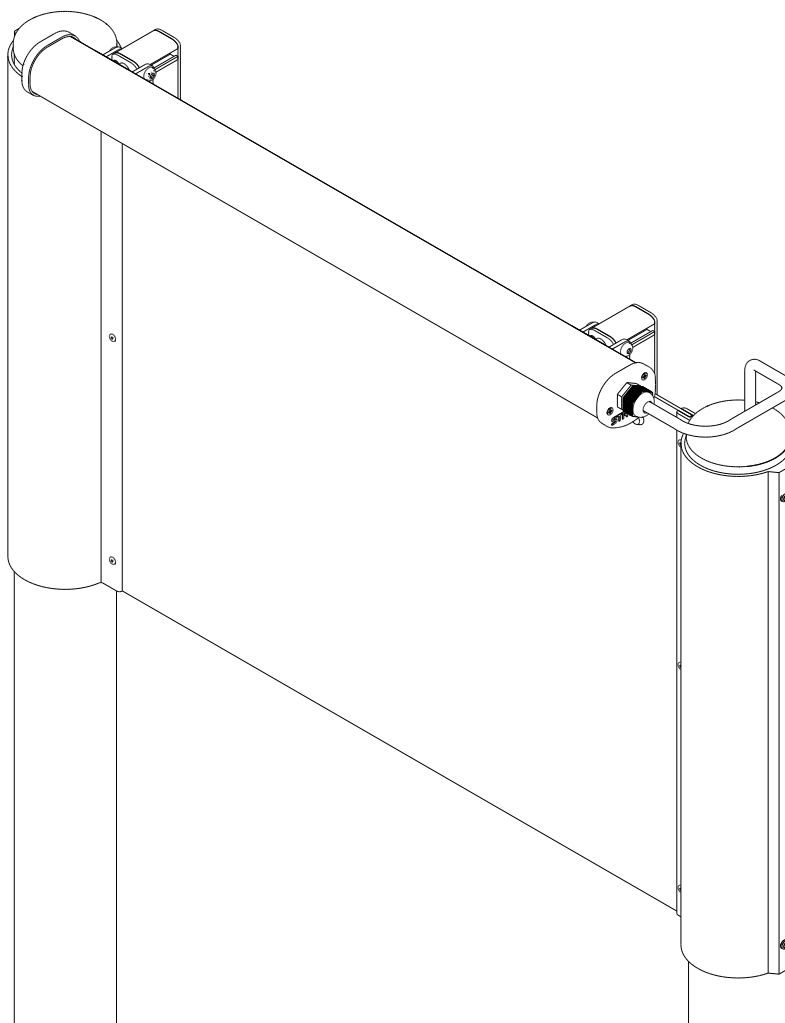

Double Sided Bracket Mounting

Tools Required

- Screwdriver
- Hex Key



Step 1:

Fix the Bracket legs to the top of the Double Sided Plaza Tray in the desired position (screwdriver & hex key required)

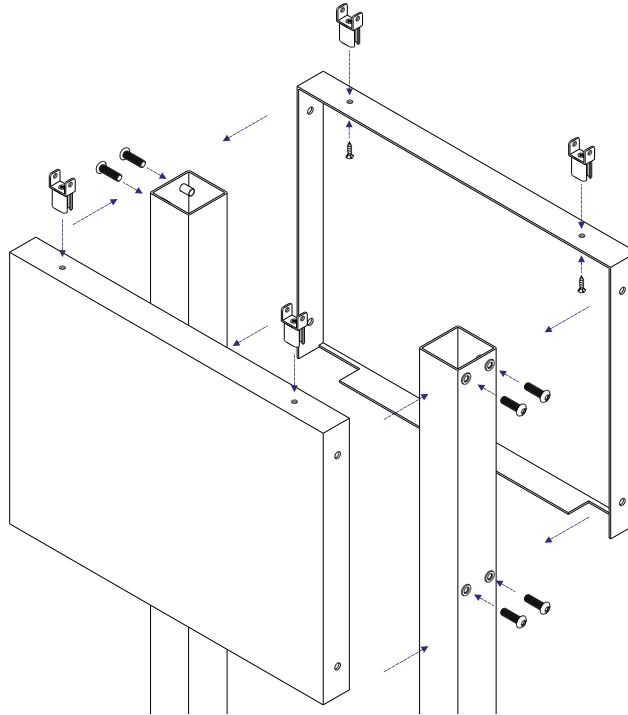

Step 2:

Slide the top of the Bracket (Arm Extrusion) into position (centrally between brackets), then tighten into position using the external tooth washers and M6 bolts

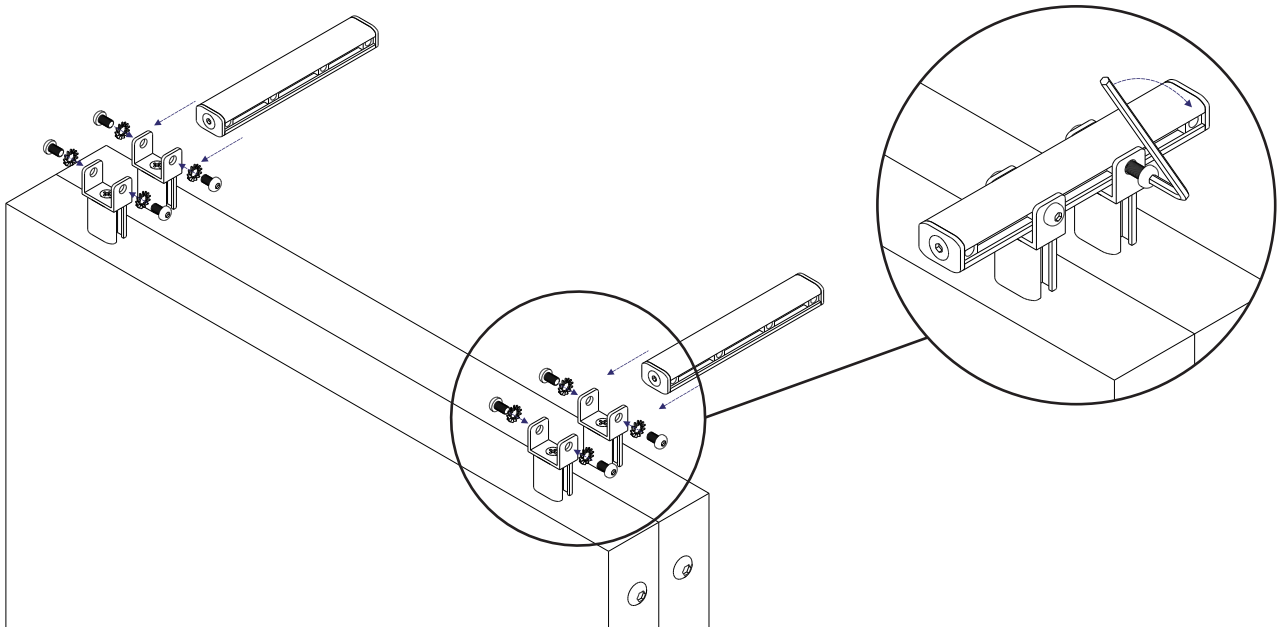

Step 3:

Slide the Main Stryder Troughlight Extrusion with the Slider Brackets onto the Double Sided Brackets and bolt into place using the external tooth washers and M6 bolts.

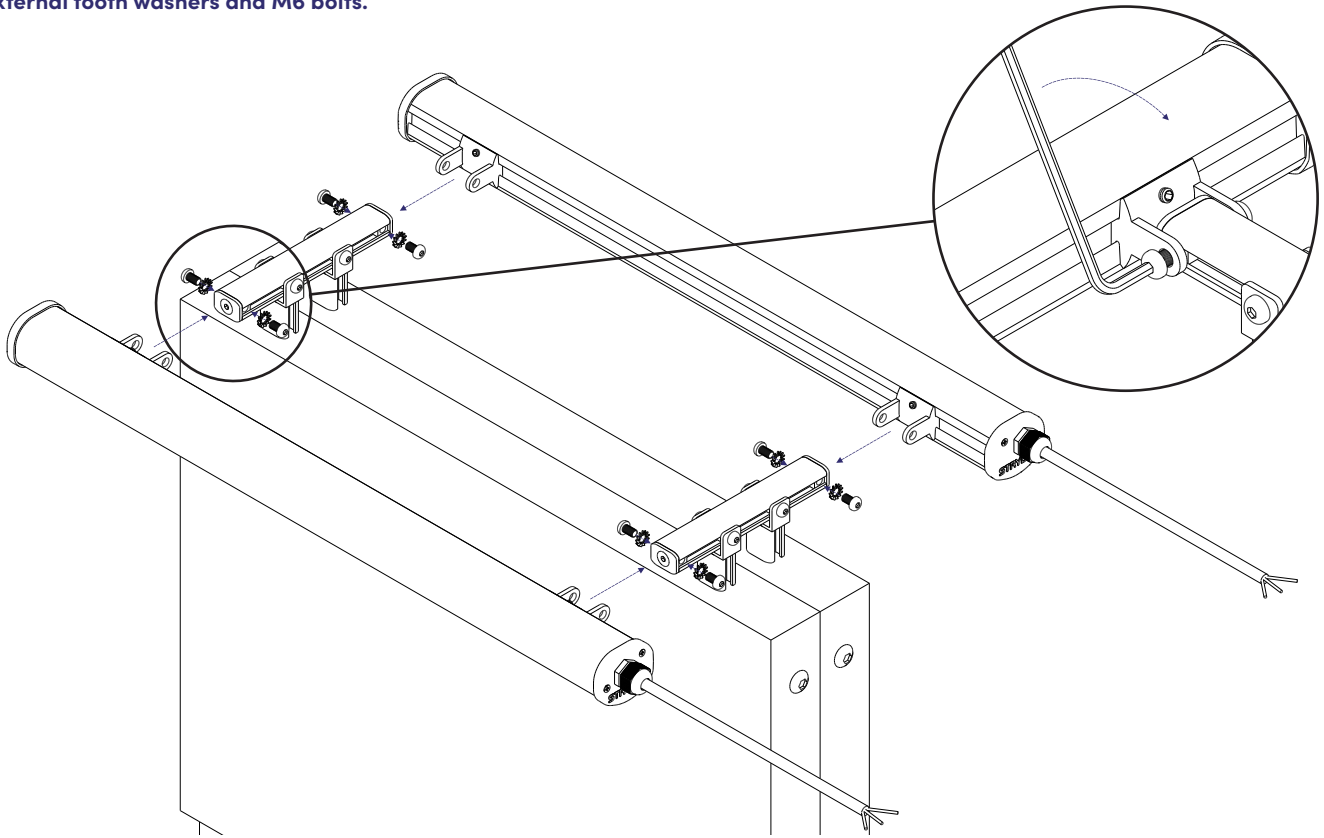

Step 4:

Slide the troughlight into the correct position and then tighten the Grub Screws in the Slider Bracket to hold in place.

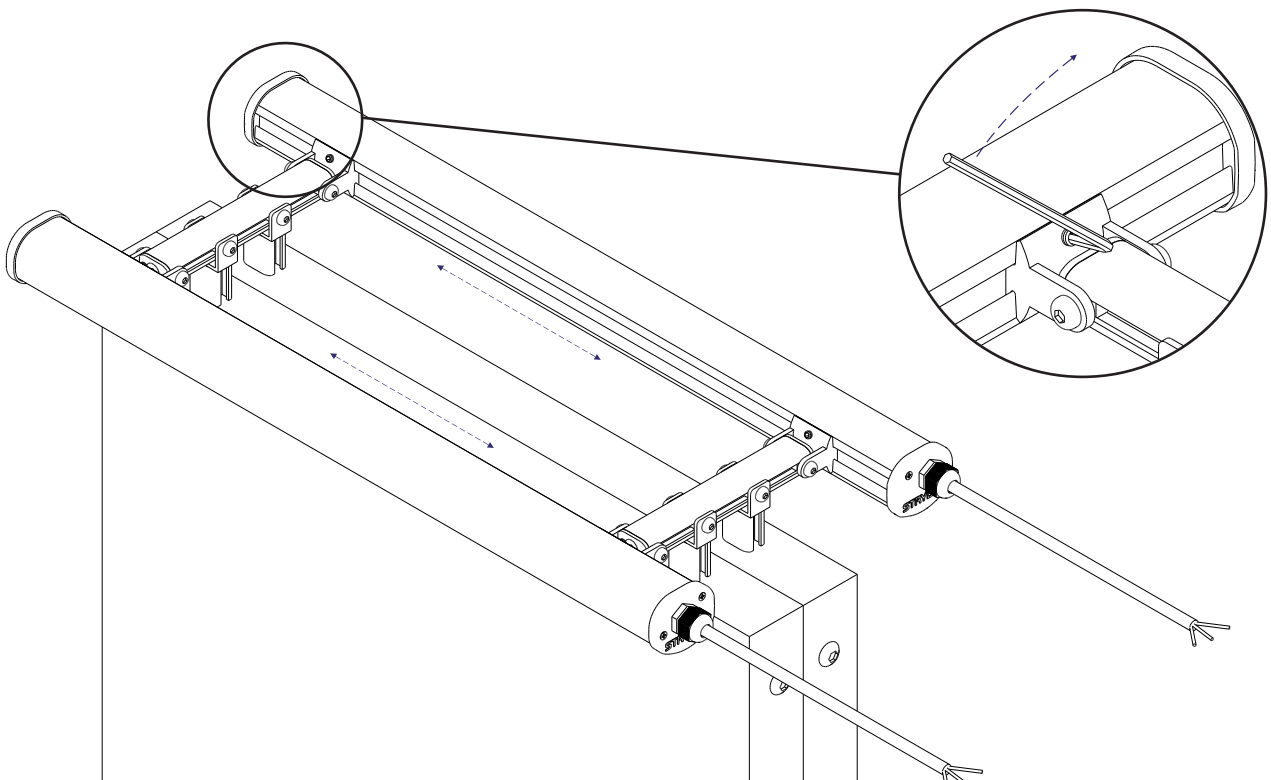

Step 5:

Connect the 3-core cable and the troughlight is complete - Get a qualified electrician to connect your 240V Cable to the mains.

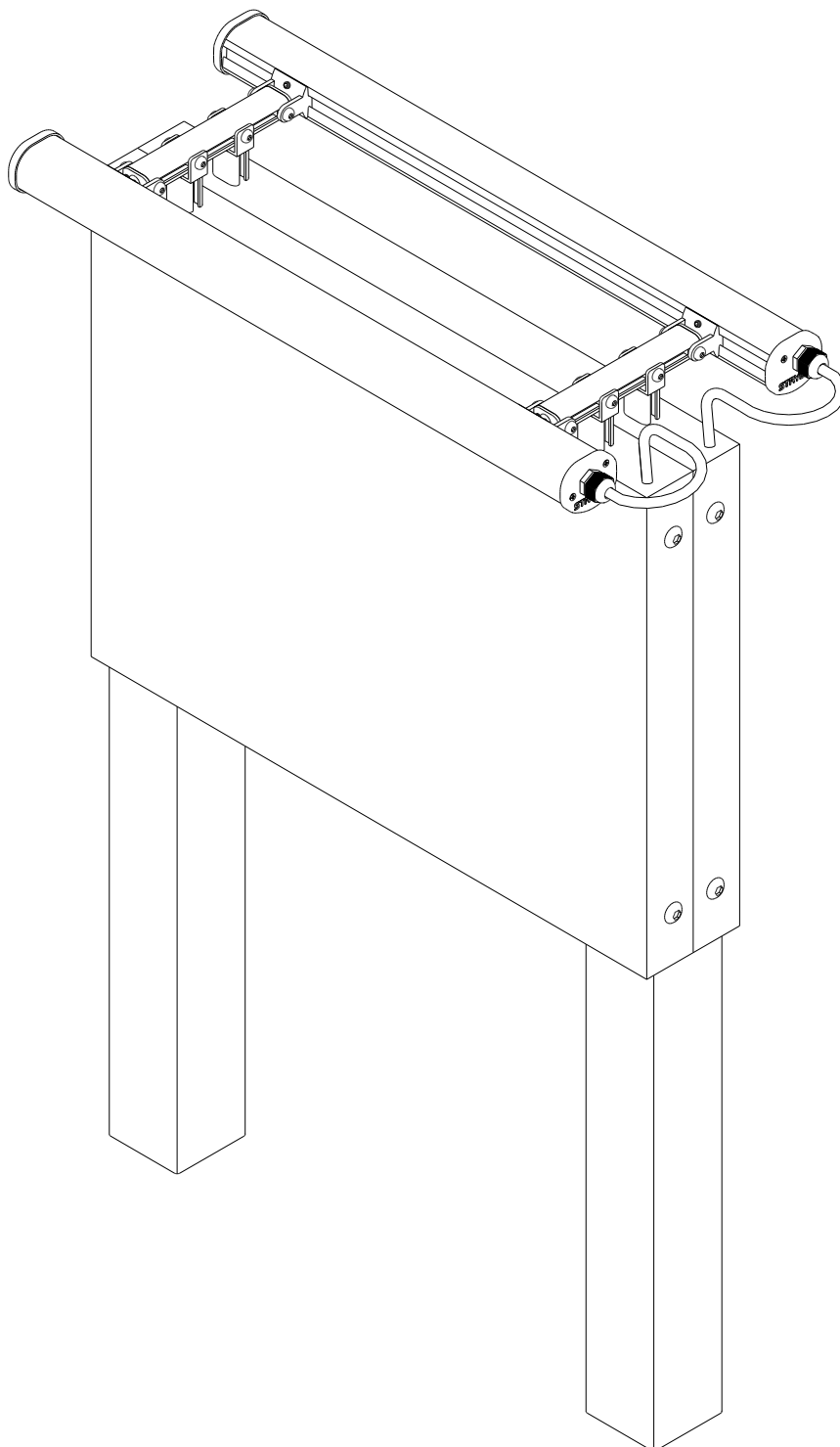

Optimum Illumination Chart

Sign Lighting/Trough Light

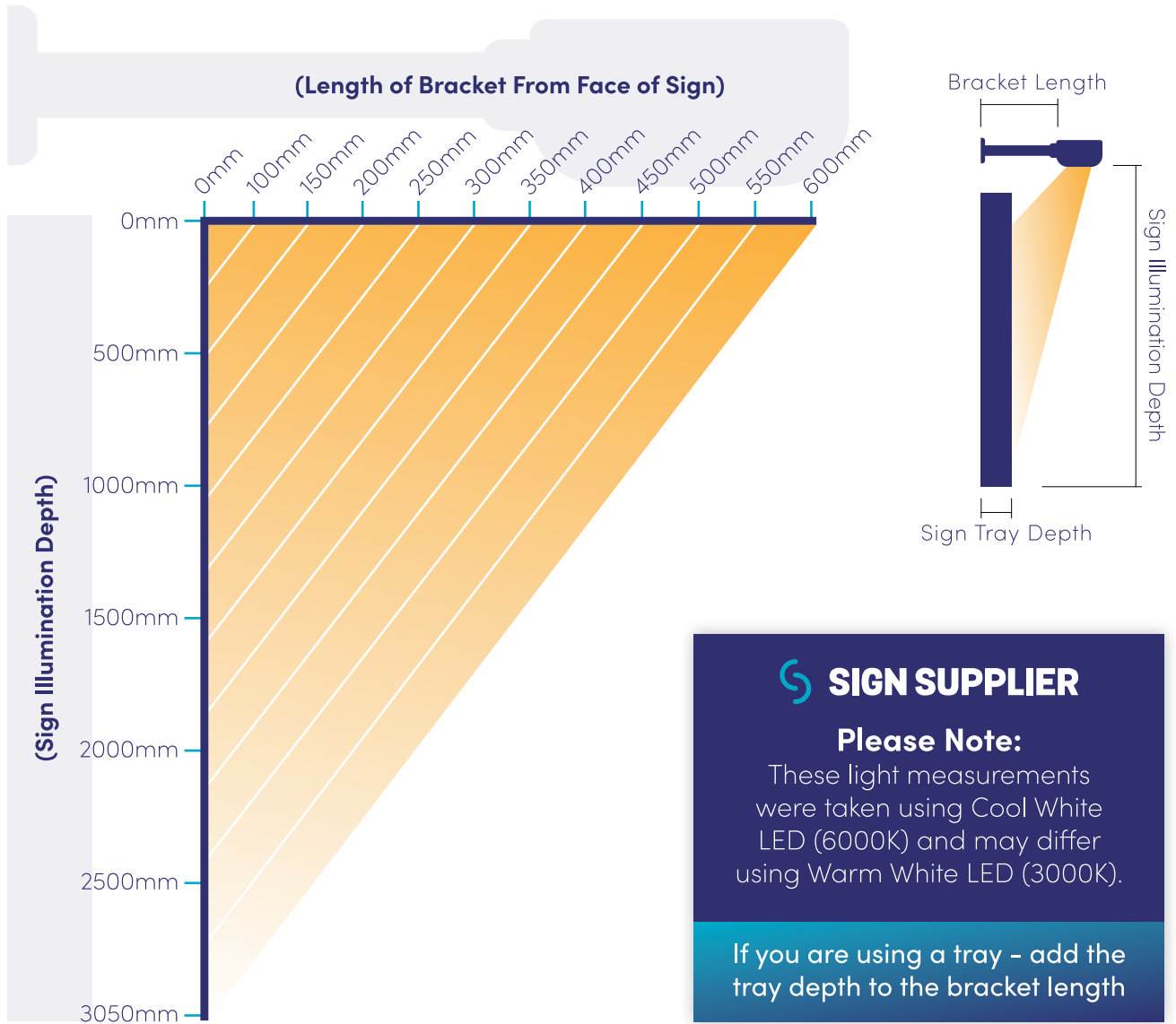

Contact Us

Main Office

Sign Supplier
 Unit 15 Dale Industrial Estate
 Radcliffe
 Manchester
 M26 1AD

Contact

0800 133 7555
 info@signsupplier.co.uk



SIGN SUPPLIER